

GOOD

BUILD AN ICF SAFE ROOM & FOUNDATION

ICF Safe Rooms are like any other room in your home: master bathroom, bedroom, closet, pantry, media room and more.

A temperature controlled room that isn't musty or damp inside your home for your family's safety. No worries about moving cars and climbing down into a hole in your garage, ICF safe rooms can be above ground or in your basement. ICF safe rooms also prevent you from being trapped under debris in your garage waiting for rescue.

BETTER

BUILD AN ICF BASEMENT AND FOUNDATION

Build your crawlspace or basement with ICFs and create a safe place for you and your family. Highly energy-efficient ICF basements typically are drier with lower humidity than standard basements. ICF basements are insulated, waterproof, quiet, and an excellent value.

ICF basements let you maximize the square footage of your home regardless of your lot size.

BEST

BUILD ALL THE OUTSIDE WALLS OF YOUR HOME USING ICFs FOR MAXIMUM BENEFIT.

Build all outside walls of your home using ICFs. The insulation below ground in your foundation or basement are even greater above ground.

Any cost difference is recouped within the first 3-5 years of owning your home. The actual out of pocket cost difference is offset by energy savings alone compared to wood frame construction.

This means while your mortgage might be slightly higher, the monthly utility bills will be substantially lower and your total monthly out of pocket costs are the same.

Benefits such as safety from disaster, noise reduction, improved indoor air quality, and peace of mind begin immediately and never stop.

ICF MYTHS

ICFs ARE TOO EXPENSIVE... ICFs cost 3%-7% more on average compared to using traditional wood construction. This difference can be reduced by smaller HVAC requirements, energy-efficiency tax breaks, and lower utility bills for the lifetime of your home.

ICFs ARE TOO COMPLICATED TO USE... Building with ICFs is like any other technology. Make sure your ICF installer is well trained and is familiar with the product. ICFs in general are simple enough for DIY and even simpler than building with wood.

I CAN GET THE SAME EFFICIENCY WITH WOOD... Wood structures can be built with high energy-efficiency ratings, but they cannot achieve the same low level of air infiltration or thermal mass ICF walls provide. ICFs also resist natural disasters including fire, earthquakes, tornadoes, high winds and hurricanes, unlike wood structures.

ONLY UNDERGROUND SAFE ROOMS WILL PROTECT MY FAMILY... This myth has been circulating for years in the media and has no basis in fact. Scientific testing at Texas Tech University and by FEMA proves that shelters built to FEMA guidelines are capable of easily withstanding an F5 Tornado.

ICFs ARE ONLY GOOD IN REALLY COLD CLIMATES... ICFs are excellent in all types of climates. They provide exceptional insulating value and are safer, quieter, and disaster resistant. ICFs are future-proofed for tomorrow's building codes today.

CONCRETE HOUSES ARE UGLY AND UNATTRACTIVE... ICF homes look like any other home. The outside uses the same brick, rock, stucco, or siding. The inside is even more inviting and comfortable. The only noticeable difference will be slightly deeper window sills and door jambs. Oh, and lower utility bills every month.

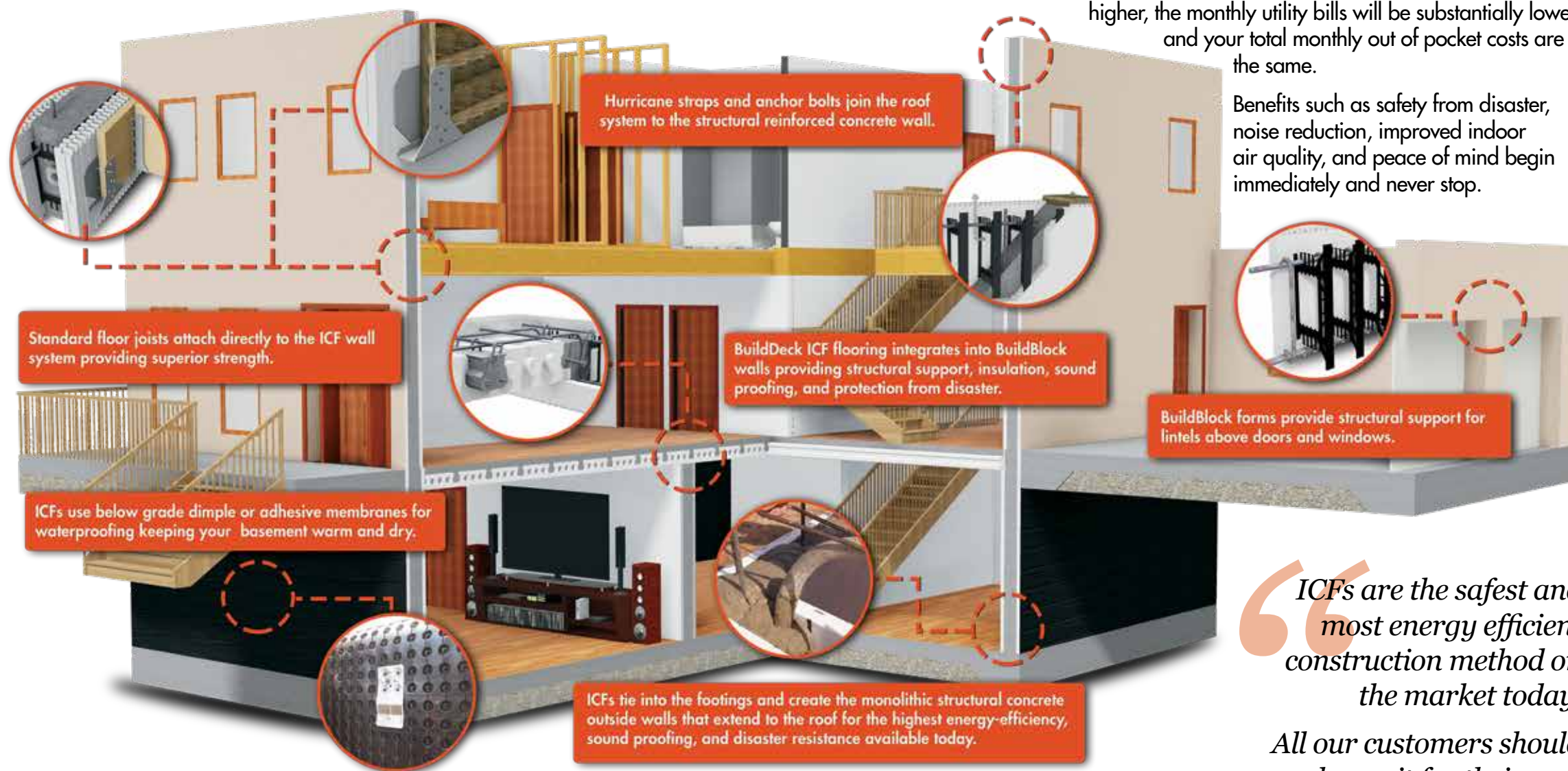

“ICFs are the safest and most energy efficient construction method on the market today.”

All our customers should choose it for their next home, we will.

Michael & Steph Nelson
Nelson Design Group, LLC

PROVERBS 24:27

HOW AN ICF HOUSE IS BUILT

CONTACT BUILDBLOCK TODAY!
866-222-2575
BUILDBLOCK.COM

WHAT ELSE CAN YOUR SAFE ROOM DO?



ICF Safe Rooms are like any other room in your home: master bathroom, bedroom, closet, pantry, media room and more.



Building a safe room doesn't mean building an ugly bunker. Your ICF safe room can be any room you want and you can use it as a part of your home each day.

Add an ICF safe room to existing homes or new construction today!

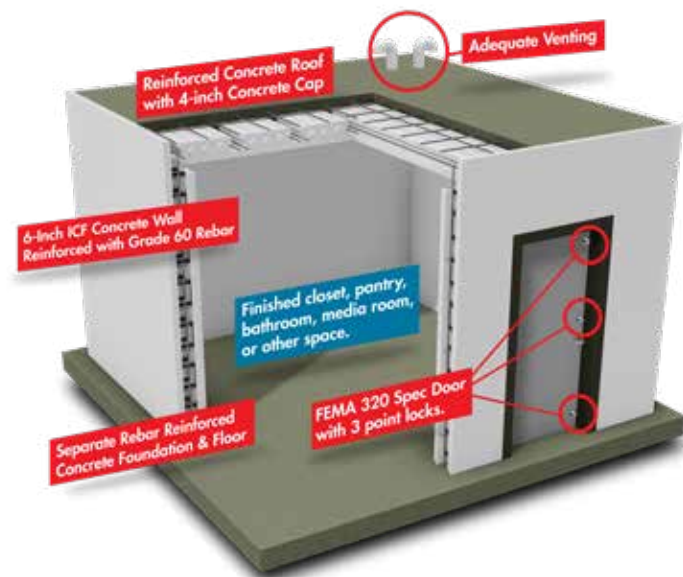

WHAT ARE INSULATING CONCRETE FORMS (ICFs)?

Insulating Concrete Forms (ICFs) are steel-reinforced concrete walls with foam insulation on both sides ready to be finished with brick, siding, or stucco on the outside and sheetrock on the inside.

ICFs are made from two 2.5-inch thick expanded polystyrene (EPS) foam panels with embedded high density plastic webs connecting them. The EPS foam provides a moisture barrier and extreme insulation value. The webs provide structure during construction and attachment points for sheetrock, brick ties, siding, cabinets, shelving or other interior and exterior finishes.

The ICF blocks are stacked in the shape of the outer walls of your home, school, church, or office building.

Once stacked and lined with reinforcing steel rebar, they are filled with concrete. The foam stays in place and provides insulation. The thick concrete creates thermal mass which takes longer to change temperature keeping the temperature inside more stable and resisting weather changes.

ICFs provide extreme energy-efficiency, noise control, decreases allergens and can resist many natural disasters.

ICFs were designed to build energy-efficient and disaster resistant homes and buildings. These products stand up against the worst Mother Nature has to offer: snow, wind, rain, hail, fire, tornadoes, earthquakes, heat, cold, dust and more. Building with Insulating Concrete Forms creates an energy-efficient wall with

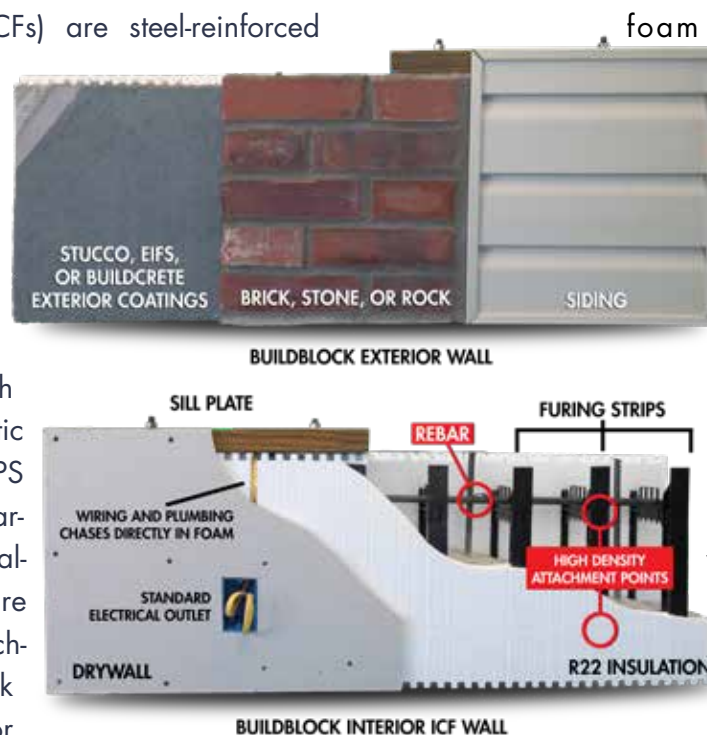

foam insulation on both sides and reinforced concrete in the middle that keeps the weather outside and you comfortable on the inside. The high insulation and low air loss means you get extreme energy savings each and every month.

Brick, stucco, rock, siding and more; ICF homes look like any other, except after a disaster. Building dry basements are easy with ICFs. Use them all the way to the roof for the best value for your home. Add a safe room to an existing home, room addition, or convert a closet or

bathroom in your new home and give yourself added peace of mind.

WHY SHOULD I CHOOSE ICFs FOR MY HOME?



ICFs are one of the most durable and long-lasting building materials available today. Concrete structures have survived for centuries. ICFs add superior insulation value, energy-efficiency, enhanced air quality, and noise reduction. Ultimately you have a home that yields a solid return on your investment for decades.

Choosing BuildBlock ICFs is more than choosing a building material. It's building a sustainable, energy-efficient, and safe place for you and your family. Choose BuildBlock today.

BuildBlock
INSULATING CONCRETE FORMS
1-866-222-2575
BUILDBLOCK.COM



Build it once. Build it *for life.*



BUILD SAFE HOMES AND SAFE ROOMS

ICF homes save you money every month and a safe room keeps you and your family safe during disasters. Make any closet, bathroom, or other space a safe room.

- **40-60% ENERGY SAVINGS** - The foam insulation plus the thermal mass of the concrete keeps the temperature inside your home constant.
- **DISASTER RESISTANT** - ICFs are filled with steel-reinforced concrete which provides the best protection from earthquakes, fire, tornadoes, hurricanes, and more.
- **QUIET** - ICF walls are more than twice as quiet as wood framed homes with an STC rating of 50+.
- **BETTER AIR QUALITY** - No air moves through ICF walls keeping dust, dirt, mold, and other allergens outside where they belong.
- **GREATER FIRE PROTECTION** - ICFs have a 4-hour fire rating keeping your home safer from fire and protecting your family.
- **GREEN & ENVIRONMENTALLY FRIENDLY** - ICFs have extremely low construction waste, are made from recycled materials, and create structures designed to last for centuries.
- **10X STRONGER THAN WOOD** - Five inches of foam insulation is combined with steel-reinforced concrete providing the strongest form of construction available.
- **EASY BASEMENT & SAFE ROOM CONSTRUCTION** - ICFs are great not only for basements and safe rooms, but also for your entire home. Use ICFs all the way to the roof for the most energy savings, comfort, and security.